



NEXLER Izofol Roof

Protective and decorative coating for the roof

TECHNICAL DATA

Composition	polymer dispersion, water, filler, technological additives
Available colours	red, brown, white, graphite, grey
Density	1,20 - 1,30 g/cm ³
Number of layers	2 - 3
Residual dry compound	no less than 60%
Time interval between applying following layers: - sheet metal, wood, concrete - top layer bituminous felt, bituminous shingles	approx. 4 h approx. 6 h
Water vapour permeability	class I
Capillary absorption and permeability to water	< 0,1 kg/m ² × h ^{0,5}
Adhesion strength by pull off test	≥ 0,8 (0,5) ^a N/mm ²
Consumption: - sheet metal, wood, concrete - top layer bituminous felt, bituminous shingles	0,15 - 0,25 kg/m ² per layer 0,4 - 0,6 kg/m ² per layer
Application temperature	from +5°C to +30°C
Reference document(s)	EN 1504-2:2004

^a The value in brackets is the lowest accepted value of any reading.

PROPERTIES

- Creates a flexible coating
- Resistant to UV radiation
- Adheres well to substrates, especially to bituminous felts
- Covers microcracks
- Has thixotropic properties



APPLICATION

- Creating flexible protective and decorative coatings on flashings and roof coverings such as: bituminous felt, bituminous shingles, ceramic tiles, steel tiles and galvanized steel sheets
- Creating protective and decorative coatings of concrete elements, masonry and plasters



PACKAGING

Poland

- Plastic buckets:
5 kg, 10 kg, 25 kg
- Number of packages per pallet:
- 5 kg - 80 pcs.
- 10 kg - 60 pcs.
- 25 kg - 33 pcs.

Export

- Plastic buckets:
5 kg, 10 kg, 25 kg
- Number of packages per pallet:
- 5 kg - 80 pcs.
- 10 kg - 60 pcs.
- 25 kg - 33 pcs.

METHOD OF USE

CONDITIONS OF USE

The temperature of the substrate and air during the works should be from +5°C to +30°C. Works should not be carried out during precipitation and strong sunlight.

During the works, very good ventilation of the work area should be ensured.

SUBSTRATE PREPARATION

Substrate made of bituminous felt must be load-bearing, free from any impurities, anti-adhesion agents. Old layers of bituminous felt with poor adhesion, brittle and flaking, should be removed. Fill in the defects with weldable bituminous felt or putty e.g. NEXLER Arbolex Aqua Stop so as to make the surface of the roof even.

Roof coverings made of clay or cement tiles should be cleaned of moss, lichen and other impurities that hinder the adhesion of the coating. Roof slopes covered with tile or trapezoidal sheet metal should be cleaned of loose paint coverings, degreased, traces of corrosion should be removed and anti-corrosion protection should be applied. Prepared absorbent substrates should be primed with NEXLER Gruntofol priming solution.

PRODUCT CONTROL

Check the production date on the packaging before use. The product should not be incorporated beyond its shelf life. The product should not be objectionable (e.g. contain lumps, fibres, mechanical contaminants) after opening. The product may have a uneven color, which is not constitute a defect in the product. Before use, it should be thoroughly mixed to achieve a uniform shade and the appropriate consistency. Do not use a product that bears signs of freezing.

PRODUCT PREPARATION

Izofol Roof is a ready-to-use product. The product should be mix thoroughly before use. Before use, the product should be mixed with a low-speed stirrer (250 - 300 rotations per minute) until a homogeneous mass is obtained, taking care not to aerate the mixture. When using product from different production batches, the product from all batches should be mixed thoroughly in a large container to achieve colour uniformity. During longer painting periods, repeat the stirring from time to time.

In case of airless spraying application, the product can be diluted with water up to a maximum of 5% by weight, provided that it is thoroughly mixed.

APPLICATION METHOD

Izofol Roof should be applied in two or three layers (sensitive areas, substrates with difficult-to-cover colour) using a brush, roofing brush, paint roller or airless spraying equipment. Apply each layer after the previous one has dried. Thickness of an individually applied layer should not exceed 0,8 mm. At vertical/horizontal joints

(e.g. roof slope with chimney) it is recommended to reinforce the **Izofol Roof** coating by embedding a technical fabric (e.g. polypropylene fabric of 50 - 60 g/m² weight) into the first layer, turning it up to the appropriate height. When embedding the fabric, care should be taken to remove air bubbles and to thoroughly saturate it with the compound. In this case another layer of **Izofol Roof** can be applied not earlier than after 24 hours.

A fresh coat of **Izofol Roof** should be protected during drying against too rapid evaporation of water, wide temperature differences, contact with water or excessive moisture and frost.

CONTROL OF PERFORMANCE

Thickness of a layer should be controlled by checking the material consumption on a dedicated surface.

Properly made layer, after drying, should be a uniform, clean coating, without blisters, flakes and other defects. The coating should adhere closely to the primed substrate.

TOOLS AND TOOL CLEANING

Low-speed stirrer, brush, paint roller, roofing brush. For spray application use eg. Wagner ProSpray 3.20 with nozzle 521.

Wash tools with water during and after work and leave to dry. If the product dries, clean mechanically. Clean the spray equipment immediately after work, according to the equipment manufacturer's recommendations.

STORAGE AND TRANSPORT

The shelf life of the product is 12 months from production date specified on the packaging. Store in dry and cool rooms, at temperature above +5°C, in tightly sealed, original packaging. Do not allow the product to freeze or long exposure to high temperatures or sunlight during storage and transport.

NOTES

Works should be carried out in accordance with technical conditions, manufacturer's instructions, health and safety standards and regulations.

For information on how to deal with symptoms of disease, allergies or irritation of the skin or eyes, please refer to the Safety Data Sheet (www.nexler.com).

After works are finished, hand over the remaining content of the product and the container to authorised companies.

GENERAL RECOMMENDATIONS

Technical data and information on the method of use are given for a temperature of 23°C ± 2°C and a relative air humidity of 55%. In other conditions, the setting (drying) time may change significantly.

The consumption of the product given in this sheet depends on the preparation of the substrate.

Individual batches of the product may vary slightly in shade of colour.

The product can be applied to surfaces with any slope that ensures water run-off.

Izofol Roof must not be used on tar materials.

The coating made of **Izofol Roof** is not intended for permanent pedestrian traffic or other communication.

It is permitted to weld a new bituminous felt covering onto existing **Izofol Roof** coatings, provided that all loose and unbonded layers are first removed and the surface is thoroughly cleaned and dried. Before starting the work, it is recommended to assess the technical condition of the substrate.

SAFETY INFORMATION

May cause an allergic skin reaction. Harmful to aquatic life with long lasting effects. If medical advice is needed, have product container or label at hand. Keep out of reach of children. Wash hands and exposed parts of the body thoroughly after handling. Wear protective gloves/protective clothing/eye protection/face protection. Dispose of contents/container according to the instructions of the manufacturer or person authorized to dispose of waste.

IMPORTANT INFORMATION

Please refer to the detailed conditions of use of the product before use.

We guarantee the quality of our materials as part of our terms of sale and delivery. For buildings with special requirements that are not covered by this manual, we provide our Customers with our own professional advisory service.

The manufacturer has no influence on the improper use of the material, its use for other purposes or under conditions other than those described above. The guarantee only covers the quality of the delivered product. The correct and therefore effective use of the product is not subject to our control.

Neither the manufacturer nor his authorized representative may be held liable for any loss incurred as a result of improper use or storage of the product.

Employees of the company are authorized to provide technical information only and solely in accordance with this Technical Data Sheet. Information other than that contained in this sheet should be confirmed in writing.

If you have any doubts, consult the manufacturer.

CONTACT DETAILS

NEXLER sp. z o.o.

Łużycka 6, 81-537 Gdynia, Poland

tel.: +48 58 712 94 44

www.nexler.com

e-mail: dt@nexler.com

ISSUE DATE

This Technical Data Sheet was issued on 26.03.2026.

Once we have issued a new Technical Data Sheet, this one is no longer valid.

DETAILS

Renovation of a flat roof

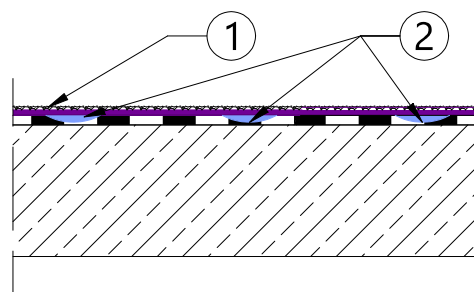

1. Renovation layers - **NEXLER Izofol Roof**
2. Filling of defects in the old bituminous felt coating - **NEXLER Arborex Aqua Stop**