



# NEXLER W 400/1200

## Top layer bituminous felt

### TECHNICAL DATA

Type of reinforcement	building cardboard
Top finishing	coarse grained
Low temperature flexibility	$\leq 0^{\circ}\text{C}$
Width	$\geq 0,99\text{ m}$
Straightforwardness	$\leq 15\text{ mm per }7,5\text{ m of roll length}$ $\leq 20\text{ mm per }10\text{ m of roll length}$
Basis weight	$2,6\text{ kg/m}^2 \pm 10\%$
Resistance to external fire exposure	NPD
Reaction to fire	class E
Watertightness: waterproof at a pressure	$\geq 10\text{ kPa (method A)}$
Maximum tensile force: - longitudinal extension - transversal extension	$500 \pm 300\text{ N/50 mm}$ $(3 \pm 2)\%$ $400 \pm 200\text{ N/50 mm}$ $(3 \pm 2)\%$
Resistance to root penetration	NPD
Resistance to tearing: - longitudinal - transversal	$70 \pm 30\text{ N}$ $70 \pm 30\text{ N}$
Dimensional stability	$\leq 0,3\%$
Durability: flow resistance at elevated temperature	$(80 \pm 10)^{\circ}\text{C}$
Reference document(s)	EN 13707:2004+A2:2009

### PROPERTIES

- 1 year warranty
- Fixed with asphalt adhesives and mechanically



ECONOMICAL  
SOLUTION

### APPLICATION

- Multi-layer coverings for flat roofs on stable substrates
- Multi-layer coverings for pitched roofs



FIXED WITH  
ASPHALT ADHESIVE



MECHANICAL  
FASTENING

### PACKAGING

#### Poland

- Roll length: 7,5m; 15m
- Quantity per pallet:  
- 7,5 m - 35 rolls (262,5 m<sup>2</sup>)  
- 15 m - 20 rolls (300 m<sup>2</sup>)

#### Export

- Roll length: 7,5m; 15m
- Quantity per pallet:  
- 7,5 m - 35 rolls (262,5 m<sup>2</sup>)  
- 15 m - 20 rolls (300 m<sup>2</sup>)

## METHOD OF USE

### ■ CONDITIONS OF USE

Making an insulation using bituminous felt should be **NEXLER W 400/1200** carried out according to the technical design, in accordance with the current building regulations and the detailed guidelines for the design and execution of insulation contained in NEXLER Insulation Systems and the Technical Data Sheet.

The bituminous felt should be installed in ambient temperatures of above +5°C, this requirement applies to the time of day and night.

Do not carry out insulation work during strong winds and precipitation.

### ■ SUBSTRATE PREPARATION

The substrate should meet the following requirements:

- dry substrate (without visible traces of moisture and darkening caused by moisture, the humidity of the concrete or cement finishing coat substrate must not exceed 6% and the humidity of the plank substrate must not exceed 21%),
- clean substrate (the surface is free of dust, oil stains, grease and other contaminants),
- smooth substrate (local unevenness and cavities in the surface of concrete do not exceed  $\pm 5$  mm),
- even substrate (the gaps between the surface of the substrate and a 4 m long patch placed on the concrete substrate do not exceed 10 mm).
- roof slope inclination min. 3%.

When renovating old bituminous coverings, it is recommended to prime the old bituminous layers with water-based asphalt preparations, e.g. NEXLER BITFLEX Primer (diluted with water) or other bituminous primers manufactured by NEXLER sp. z o.o.

### ■ PRODUCT CONTROL

The product should not raise any objections. The roll should be evenly rolled, without kinks.

### ■ PRODUCT PREPARATION

If it is necessary to make the covering at low ambient temperatures, it is recommended to store the rolls in heated rooms at a temperature of not less than +18°C for 24 hours before installation.

### ■ APPLICATION METHOD

**NEXLER W 400/1200** bituminous felt should be bonded to previously installed underlayer bituminous felt or to old, renovated and primed bituminous felt covering. Application should be carried out after the priming agent has completely dried (or cured). The bituminous felt can be installed using nails and washers directly to the wooden substrate, provided that the overlaps of the felt are glued with asphalt adhesive e.g. NEXLER Cold Glue, which should also be applied to the visible nails and washers.

On roofs with a slope of more than 20%, two layers of **NEXLER W 400/1200** bituminous felt are required, while on roofs with a slope of 3% or more, three layers of bituminous felt are required. In individual roof covering layers, the bituminous felt sheets should be shifted relative to each other by 1/2 of the sheet width in the case of two-layer roof covering, and by 1/3 of the sheet width in the case of three-layer roof covering.

**NEXLER W 400/1200** bituminous felt should be glued using only asphalt adhesives in accordance with the recommendations of their manufacturers. When using cold-applied asphalt adhesives, e.g. NEXLER Cold Glue, ensure sufficient time for the solvents contained in the applied layer of asphalt adhesive to evaporate (from approx. 30 minutes to 2 hours in summer and more in periods when the ambient temperature is approx. +10°C). **NEXLER W 400/1200** bituminous felt and cold-applied asphalt adhesives for gluing bituminous felt should not be used at ambient temperatures below +10°C. The application temperature of hot-applied asphalt adhesive should be between +160°C and +180°C. The bituminous felt sheets should be joined with overlaps of no less than 10 cm in width and the length of the glued roofing felt section must not exceed 8 m. On roofs with a slope of less than 30%, attach the roofing felt strips parallel to the eaves and on roofs with a slope of more than 30% perpendicular to the eaves.

### ■ CONTROL OF PERFORMANCE

During acceptance, the following should be checked:

- correctness of bonding of overlaps,
- adhesion of the bituminous felt to the substrate,
- correctness of detail work.

## WARRANTY

The manufacturer NEXLER sp. z o.o. provides the direct purchaser of **NEXLER W 400/1200** bituminous felt:

- a standard material warranty of 1 year.

Details of the guarantee provided to the purchaser are contained in the guarantee card.

## TOOLS AND TOOL CLEANING

Hammer, spatula.

## STORAGE AND TRANSPORT

The rolls of **NEXLER W 400/1200** bituminous felt are protected with packing tapes before unrolling. Each roll has a label with the required data on it. The rolls are placed vertically on wooden industrial pallets and foiled.

During transportation and storage, the rolls must be protected from moisture and exposure to sunlight, and be placed upright in one layer in a way preventing any dislocation or damage.

The bituminous felt rolls must be stored on a flat surface at a distance of at least 120 cm from radiators.

Transportation must be carried out in compliance with applicable shipment safety regulations.

## NOTES

Works should be carried out in accordance with technical conditions, manufacturer's instructions, health and safety standards and regulations. Before applying the top layer bituminous felt, make sure that the next roll to be unrolled does not differ in the shade of the sprinkles. The sprinkle is a natural raw material and may vary in shade.

## IMPORTANT INFORMATION

Please refer to the detailed conditions of use of the product before use.

We guarantee the quality of our materials as part of our terms of sale and delivery. For buildings with special requirements that are not covered by this manual, we provide our Customers with our own professional advisory service.

The manufacturer has no influence on the improper use of the material, its use for other purposes or under conditions other than those described above. The guarantee only covers the quality of the delivered product. The correct and therefore effective use of the product is not subject to our control.

Neither the manufacturer nor his authorized representative may be held liable for any loss incurred as a result of improper use or storage of the product.

Employees of the company are authorized to provide technical information only and solely in accordance with this Technical Data Sheet. Information other than that contained in this sheet should be confirmed in writing.

If you have any doubts, consult the manufacturer.

## CONTACT DETAILS

NEXLER sp. z o.o.

Łużycka 6, 81-537 Gdynia, Poland

tel.: +48 58 712 94 44

www.nexler.com

e-mail: dt@nexler.com

## ISSUE DATE

This Technical Data Sheet was issued on 25.02.2025.

Once we have issued a new Technical Data Sheet, this one is no longer valid.

## DETAILS

### Covering on a wooden pitched roof

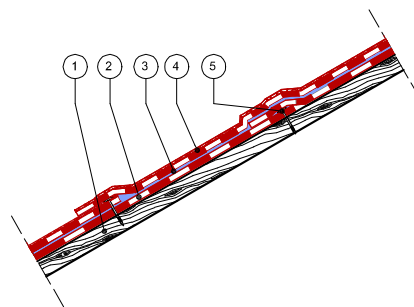

1. Planks or OSB
2. Top layer bituminous felt **NEXLER W 400/1200**
3. NEXLER Cold Glue between layers and at overlaps
4. Top layer bituminous felt **NEXLER W 400/1200**
5. Mechanical fastener