



# NEXLER Izofol Flex

Highly flexible waterproofing film in liquid form

## TECHNICAL DATA

Composition	polymer dispersion, water, filler, technological additives
Density	1,45 - 1,50 g/cm <sup>3</sup>
Number of layers	2 - 3
Maximum thickness of the applied layer	0,6 mm
Thickness of the bound coating	min. 0,5 mm
Time between applying successive layers	approx. 4 h
Setting time of the applied coating	up to 12 h for a layer of 1 mm
Initial tensile adhesion strength	≥ 0,5 N/mm <sup>2</sup> according to EN 14891 standard
Watertightness	no penetration
Crack bridging ability: - under standard conditions - at low temperature (-5°C)	≥ 0,75 mm ≥ 0,75 mm
Durability of initial tensile adhesion against climate/heat ageing action: - tensile adhesion strength after ageing	≥ 0,5 N/mm <sup>2</sup>
Durability of initial tensile adhesion against water/humidity action: - tensile adhesion strength after water contact	≥ 0,5 N/mm <sup>2</sup>
Durability of initial tensile adhesion against contact with lime water: - tensile adhesion strength after contact with lime water	≥ 0,5 N/mm <sup>2</sup>
Durability of initial tensile adhesion against freeze and freeze-thaw cycles: - tensile adhesion strength after freeze-thaw cycle	≥ 0,5 N/mm <sup>2</sup>
Water vapour permeability	class I (s <sub>p</sub> < 5 m)
Capillary absorption and permeability to water	< 0,1 kg/m <sup>2</sup> × h <sup>0,5</sup>
Adhesion strength by pull off test	≥ 0,8 (0,5) <sup>a</sup> N/mm <sup>2</sup>
Consumption	0,5 - 0,7 kg/m <sup>2</sup> per layer
Application temperature	from +5°C to +30°C
Reference document(s)	EN 14891:2012; EN 14891:2012/AC:2012; EN 1504-2:2004

<sup>a</sup> The value in brackets is the lowest accepted value of any reading.

## PROPERTIES

- Highly and permanently flexible
- Eco-friendly, does not contain solvents
- Single-component
- Frost resistant
- Provides an excellent substrate for ceramic cladding adhesives
- Microcrack-bridging
- For use on dry and damp substrates
- For use in rooms intended for human occupancy
- Hygienically certified for indoor and outdoor use



HIGHLY FLEXIBLE



FROST RESISTANT



DOES NOT CONTAIN SOLVENTS

## APPLICATION

- Creating waterproof coatings in rooms exposed to water and moisture (e.g. bathrooms, laundry rooms, kitchens) and on balconies and stairs
- Waterproofing in underfloor heating systems
- For use on vertical and horizontal surfaces



FOR INDOOR AND OUTDOOR USE



FOR VERTICAL AND HORIZONTAL APPLICATION



ROLLER



PAINT BRUSH

## PACKAGING

### Poland

- Plastic buckets:  
1,5 kg; 4 kg; 7 kg; 12 kg
- Quantity per pallet:  
- 1,5 kg - 387 pcs.  
- 4 kg - 144 pcs.  
- 7 kg - 80 pcs.  
- 12 kg - 60 pcs.

### Export

- Plastic buckets:  
1,5 kg; 4 kg; 7 kg; 12 kg
- Quantity per pallet:  
- 1,5 kg - 387 pcs.  
- 4 kg - 144 pcs.  
- 7 kg - 80 pcs.  
- 12 kg - 60 pcs.

## METHOD OF USE

### CONDITIONS OF USE

The temperature of the substrate and air during the works should be from +5°C to +30°C.

Works should not be carried out during precipitation and strong sunlight.

### SUBSTRATE PREPARATION

**Izofol Flex** can be used on cement plaster, cement-lime plaster, gypsum plasterboards, gypsum fibre boards, wood-based boards, walls made of concrete, brick, gypsum blocks, cellular concrete and on properly seasoned cement, floors etc.

The substrate must be load-bearing, stable, free from any impurities, anti-adhesion agents, cement laitance, old paint coats and other impurities reducing the adhesion of the compound to substrates. New substrates must be bound and seasoned. The substrate must not be frozen, frosty, stagnant water must not occur. Before applying the **Izofol Flex** product, prime the substrate with NEXLER Gruntfol priming agent. The substrate must be rough (porous) or be trowelled with an open finish. If the concrete substrate intended for coating with **Izofol Flex** requires reprofiling, the mortar system of the NEXLER RENOBUD R series should be used as required, according to the product application instructions.

### PRODUCT CONTROL

Check the production date on the packaging before use. Do not use the product beyond its shelf life. The product should not be objectionable (e.g. contain lumps, fibres, discolouration) after opening. After mixing, the compound should be homogeneous and free of lumps and clumps resulting from under-mixing. Do not use a product that bears signs of freezing. When properly mixed, the product forms a homogeneous coating when spread over the surface with a tool.

### PRODUCT PREPARATION

In order to prepare the **Izofol Flex** liquid sealing film to be applied, after opening the packaging, mix the product in the entire capacity of the container. This activity is best performed mechanically with a slow-speed stirrer (250 - 300 rotations per minute), paying attention not to aerate the mixture.

### APPLICATION METHOD

After the primer is applied and dried, the application of **Izofol Flex** can be started, using a brush, a roller or a steel trowel. **Izofol Flex** should be applied in a minimum of two layers. In areas exposed to strong water and moisture impact (e.g. wet room floors, balconies), the product should be applied in three layers. The thickness of an individually applied layer should not exceed 0,6 mm in a wet state. The thickness of all layers applied after they are dried should be at least 0,5 mm. Each subsequent layer should be applied after the previous one is fully bound (at least 4 hours). During the subsequent

working operation, it is recommended to apply the product in a different direction from the first (e.g. vertically, when the first application was made horizontally).

Depending on the type and intended operation of the facility to be protected, it is important to remember to use sealing tapes, e.g. 120/70 or 120/120, corners, expansion cords and sealing cuffs.

The material may retain a slight viscosity after bonding. The total drying time of the coating from the moment the final layer is applied is approximately 12 hours. As a result, the adhesive mortar has increased adhesion to the coating. Ceramic cladding can be glued directly to the fully bound waterproofing coating using adhesive mortars.

The fresh **Izofol Flex** coating, during binding, should be protected against too rapid evaporation of water, large temperature differences, contact with water or excessive moisture. Do not allow the coating and its surface to be damaged or contaminated.

The completed coating must be protected from mechanical damage caused by foot traffic, impacts, and it is therefore necessary to secure it, e.g. by laying ceramic cladding.

### CONTROL OF PERFORMANCE

Thickness of a layer should be checked by control of material consumption per unit or dedicated surface area. The thickness of the coating can also be checked using a special measuring comb. Particular attention should be paid to corners and areas where plumbing and other components pass through partitions - these need to be assessed for proper embedding of tapes, corners and cuffs. The applied coating should be continuous, free from cracks or other damage.

## TOOLS AND TOOL CLEANING

Low-speed mixer, paint brush, paint roller, steel trowel.

Wash tools with water during and after work and wipe dry. If the product dries, clean mechanically.

## STORAGE AND TRANSPORT

The shelf life of the product is 12 months from production date specified on the packaging. Store in dry and cool rooms, at temperature above +5°C, in tightly sealed, original packaging. The product must be protected from heat and direct sunlight. The product is sensitive to negative temperatures.

## NOTES

Works should be carried out in accordance with technical conditions, manufacturer's instructions, health and safety standards and regulations.

For information on how to deal with symptoms of disease, allergies or irritation of the skin or eyes, please refer to the Safety Data Sheet ([www.nexler.com](http://www.nexler.com)).

After works are finished, hand over the remaining content of the product and the container to authorised companies.

## GENERAL RECOMMENDATIONS

Technical data and information on the method of use are given for a temperature of  $23^{\circ}\text{C} \pm 2^{\circ}\text{C}$  and a relative air humidity of 55%. In other conditions, the setting (drying) time may change significantly.

The consumption of the product given in this sheet depends on the preparation of the substrate.

## SAFETY INFORMATION

Keep out of reach of children. Wear protective gloves/protective clothing/eye protection/face protection. Store in a well-ventilated place. Keep container tightly closed. Dispose of contents/container to according to the instructions of the manufacturer or person authorized to dispose of waste. Supplemental information. Contains reaction mass of: 5-chloro-2- methyl-4-isothiazolin-3-one [EC no. 247-500-7] and 2-methyl-2H -isothiazol-3- one [EC no. 220-239-6] (3:1), 1,2-benzisothiazol-3(2H)-one. May produce an allergic reaction.

## IMPORTANT INFORMATION

Please refer to the detailed conditions of use of the product before use. We guarantee the quality of our materials as part of our terms of sale and delivery.

For buildings with special requirements that are not covered by this manual, we provide our Customers with our own professional advisory service.

The manufacturer has no influence on the improper use of the material, its use for other purposes or under conditions other than those described above. The guarantee only covers the quality of the delivered product. The correct and therefore effective use of the product is not subject to our control.

Neither the manufacturer nor his authorized representative may be held liable for any loss incurred as a result of improper use or storage of the product.

Employees of the company are authorized to provide technical information only and solely in accordance with this Technical Data Sheet. Information other than that contained in this sheet should be confirmed in writing.

If you have any doubts, consult the manufacturer.

## CONTACT DETAILS

NEXLER sp. z o.o.  
 Łużycka 6, 81-537 Gdynia, Poland  
 tel.: +48 58 712 94 44  
 www.nexler.com  
 e-mail: dt@nexler.com

## ISSUE DATE

This Technical Data Sheet was issued on 22.07.2025.

Once we have issued a new Technical Data Sheet, this one is no longer valid.

## DETAILS

### Detail of pipe passage through wall

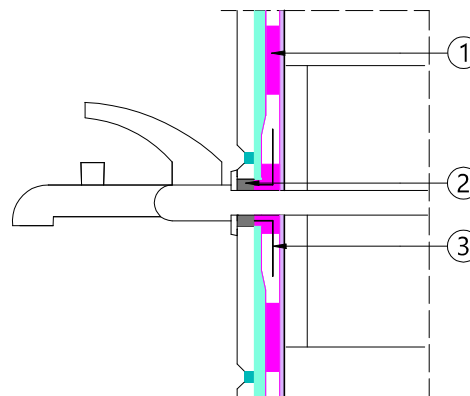

1. Liquid sealing film for under tiles **NEXLER Izofol Flex**
2. Sealant
3. Sealing sleeve

### Detail - balcony finished with ceramic tiles

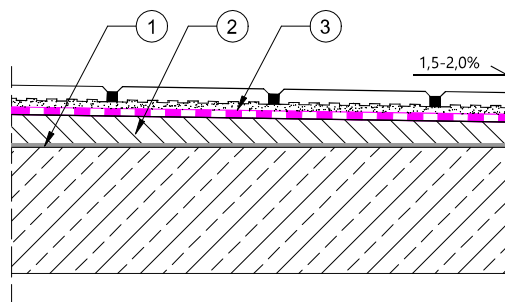

1. Bonding layer - **NEXLER RENOBUD R 102**
2. Sloping layer - **NEXLER RENOBUD R 103 / R 105**
3. Liquid sealing film for under tiles **NEXLER Izofol Flex**