



NEXLER Fix Bit

Roofing putty for repairs and sealing

TECHNICAL DATA

Composition	water-based emulsion of asphalts, fillers, rubbers, fibres and modifying additives
Density	1,01 g/cm ³
Water content in mass	no more than 60 % (m/m)
Dilution capacity of mass in water	no less than 200 % (V/V)
Vertical flowability of the coating: -within 5 h -at temperature 100 °C	does not flow
Flexibility of the coating at temperature -10 °C, when bending on a roller with a diameter of 30 mm	no scratches or cracks
Resistance to rain	2 - 5 h
Drying time	2 mm/day
Application temperature	from +5°C to +35°C
Consumption	approx. 0,5 kg/m ² /mm of wet layer
Reference document(s)	PN-B-24000:1997

PROPERTIES

- Reinforced with microfibres
- No solvents or toxic substances
- Consistency suitable for application by brush or putty knife
- Increased resistance to UV radiation
- Permanently elastic, even at sub-zero temperatures
- Quick-drying
- Bridging of cracks
- Safe in contact with EPS and XPS boards
- Very good adhesion to the substrate
- Watertight
- Prevents formation of water puddles



APPLICATION

- Filling and levelling bituminous felt and shingle substrates
- Filling cavities, scratches and cracks in roof coverings
- Repairing damage to roof coverings, including cracks, blisters and leaks
- Sealing service passages, installation culverts and flashings
- Local sealing and repair of bituminous coating waterproofing
- For use in the system together with NEXLER Reno Bit



PACKAGING

Poland

- Packaging: 1 kg, 5 kg
- Number of packages per pallet:
- 1 kg - 384 pcs.
- 5 kg - 80 pcs.

Export

- Packaging: 1 kg, 5 kg
- Number of packages per pallet:
- 1 kg - 384 pcs.
- 5 kg - 80 pcs.

METHODS OF USE

■ CONDITIONS OF USE

The temperature of the substrate and air during the works should be from +5°C to +35°C.

Works should not be carried out during precipitation and strong sunlight.

■ SUBSTRATE PREPARATION

The substrates on which **NEXLER Fix Bit** can be applied include bituminous felt, bituminous coatings, sheet metal, concrete, wood and plastics (hard PVC, PP).

NEXLER Fix Bit is designed for application on dry or matt damp substrates. The substrate must be free of frost, ice and water stagnation.

Clean the area intended for repair and filling cavities and the area surrounding it, remove all impurities and anti-adhesion layers - reducing the adhesion. Remove rust and any loose coatings from sheet metal and flashings. If necessary, protect against corrosion. Degrease the surface with a solvent, e.g. acetone. Roughen plastic substrates (if necessary) and degrease with a preparation approved by the product manufacturer.

Non-absorbent substrates (e.g. sheet metal) do not require priming. Porous and absorbent substrates (e.g. concrete) should be primed with NEXLER BITFLEX Primer.

■ PRODUCT CONTROL

Check the production date on the packaging before use. The product should not be incorporated beyond its shelf life. The product should not be objectionable (e.g. lumps, fibres, discolouration) after opening. After mixing, the compound should be homogeneous and free of lumps and clumps resulting from under-mixing. Do not use a product that bears signs of frostbite. The correct consistency of the product is not dry or rubbery. When properly mixed, the product forms a homogeneous coating when spread over the surface with a tool.

■ PRODUCT PREPARATION

NEXLER Fix Bit is a ready-to-use product. Before use, mix the product until a homogeneous mass is obtained.

■ APPLICATION

Apply **NEXLER Fix Bit** with a spatula, trowel or brush in layers no thicker than 5 mm (one layer). It is recommended to apply the roofing putty in at least two layers. If deeper unevenness needs to be evened out, it should be done in several working operations, applying each new layer after the previous one has dried.

To repair larger cavities and damage, embed 90 - 120 g/m² non-woven fabric (e.g. NEXLER NexGreen Geo 110) into the fresh layer of the compound. Spread the product evenly over a width of approximately 5 mm greater than the width of the non-woven fabric.

Embed non-woven fabric into the fresh layer of compound, pressing it thoroughly into the substrate with a pressure roller. Then cover it with a thin, even layer of **NEXLER Fix Bit**.

After the coating has dried, no sooner than the next day, cover it with another layer of **NEXLER Fix Bit** or apply a closing layer using NEXLER Reno Bit.

In places particularly exposed to sunlight, the coating can be protected with NEXLER Bituminous Felt Sprinkle. Apply the bituminous felt sprinkle to the final (wet) layer of the compound, immediately after its application.

During binding, the freshly applied layer should be protected against precipitation and strong sunlight.

Do not use at connections of materials with different susceptibility to deformation, where high stresses occur. In such places, we recommend using the NEXLER Connect system.

■ CONTROL OF PERFORMANCE

After applying, a coat should be even, continuous, free from cracks or other damage. **NEXLER Fix Bit** is brown when unbound (wet) and black when bound (dried).

TOOLS AND TOOL CLEANING

Putty knife, brush, steel trowel.

Wash tools with water during work and after their completion, and wipe dry.

STORAGE AND TRANSPORT

The shelf life of the product is 18 months from production date specified on the packaging.

Store in dry and cool rooms at temperature above +5°C, in tightly sealed, original packaging.

The product must be protected from heat and direct sunlight.

NOTES

Works should be carried out in accordance with technical conditions, manufacturer's instructions, health and safety standards and regulations.

For information on how to deal with symptoms of disease, allergies or irritation of the skin or eyes, please refer to the Safety Data Sheet (www.nexler.com).

After work the remaining content of the product and container should be handed over to authorized companies.

GENERAL RECOMMENDATIONS

Technical data and information on the method of use are given for a temperature of $23^{\circ}\text{C} \pm 2^{\circ}\text{C}$ and a relative air humidity of 55%. In other conditions, the setting (drying) time may change significantly. The setting time depends on the thickness of the applied layer.

The product consumption indicated in this sheet depends on the type, preparation and absorption capacity of the substrate.

When using felt topping, a thicker layer of compound is recommended for better embedding of the aggregate.

Do not use for tar materials.

SAFETY INFORMATION

May cause an allergic skin reaction. If medical advice is needed, have product container or label at hand. Keep out of reach of children. Wash hands and exposed parts of the body thoroughly after handling. Wear protective gloves/protective clothing/eye protection/face protection. Dispose of contents/container to according to the instructions of the manufacturer or person authorized to dispose of waste.

IMPORTANT INFORMATION

Please refer to the detailed conditions of use of the product before use.

We guarantee the quality of our materials as part of our terms of sale and delivery. For buildings with special requirements that are not covered by this manual, we provide our Customers with our own professional advisory service.

The manufacturer has no influence on the improper use of the material, its use for other purposes or under conditions other than those described above. The guarantee only covers the quality of the delivered product. The correct and therefore effective use of the product is not subject to our control.

Neither the manufacturer nor his authorized representative may be held liable for any loss incurred as a result of improper use or storage of the product.

Employees of the company are authorized to provide technical information only and solely in accordance with this Technical Data Sheet. Information other than that contained in this sheet should be confirmed in writing.

If you have any doubts, consult the manufacturer.

CONTACT DETAILS

NEXLER sp. z o.o.
 Łużycka 6, 81-537 Gdynia, Poland
 tel.: +48 58 712 94 44
 www.nexler.com
 e-mail: dt@nexler.com

ISSUE DATE

This Technical Data Sheet was issued on 09.07.2025.

Once we have issued a new Technical Data Sheet, this one is no longer valid.

DETAILS

Restoration of a flat roof

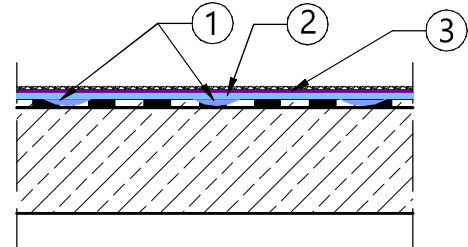

1. Filling of cavities in the old bituminous felt covering **NEXLER Fix Bit**
2. Priming layer NEXLER BITFLEX Primer
3. Restoration layers with felt topping - NEXLER Reno Bit

Restoration of a flat roof - seamless covering reinforced with non-woven fabric

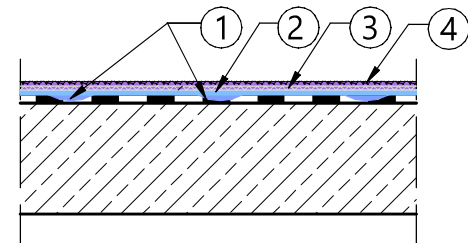

1. Filling of cavities in the old bituminous felt covering **NEXLER Fix Bit**
2. Priming layer NEXLER BITFLEX Primer
3. First layer of NEXLER Reno Bit with embedded NEXLER NexGreen Geo 110 nonwoven fabric
4. Second layer of NEXLER Reno Bit with bituminous felt sprinkle